

CP9-2E, 4E
CP9SB-2E, 4E

SERIE 900

Зип Общежит





CUOCIPASTA ELETTRICI
ELECTRIC-HEATED PASTA-COOKER
CUISEUR A PATES ELECTRIQUES
ELEKTROBEHEIZTE TEIGWARENKOCHER
COCEDOR DE PASTA ELECTRICAS

vsezip.ru

93133-20 CP9-2E
CP9-2E/2
93134-20 CP9-4E
CP9-4E/2

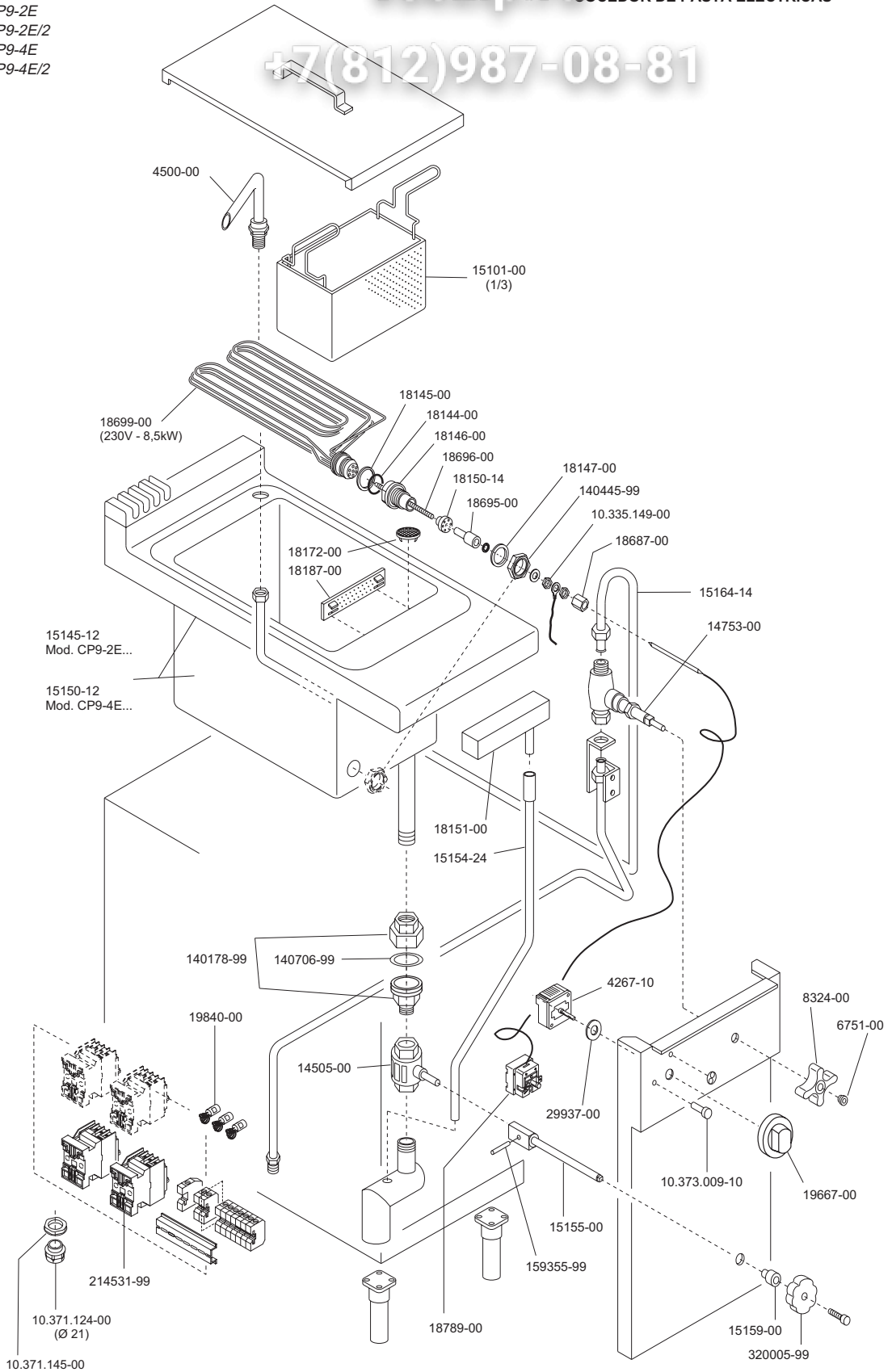
+7(812)987-08-81



| | | | | | | |
|--|-----------------------|------------|------------------------------|--------------------|-----|------------|
|  MARENO INDUSTRIE ALI spa Mareno di Piave (TV) | ELABORATO: | APPROVATO: | GRUPPO: | DENOMINAZIONE: | | |
| | <i>Platt</i> | | Serie 900 | Impianto elettrico | | |
| | DATA: | DATA: | PARTICOLARE: | REV. N. | DEL | DISEGNO N. |
| | 10 Nov 96 | 10 Nov 96 | Disegno esploso per ricambi | ▼ | ▼ | ▼ |
| SOST. DIS. | Z00 - 9611.3.9.37.CPE | | Z00 - 9611.3.9.37.CPE | | | |

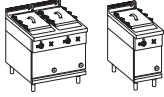

CP9-2E, 4E
CP9SB-2E, 4E
SERIE 900

Зип Общежит
vsezip.ru
+7(812)987-08-81

CUOCIPASTA ELETTRICI
ELECTRIC-HEATED PASTA-COOKER
CUISEUR A PATES ELECTRIQUES
ELEKTROBEHEIZTE TEIGWARENKOCHER
COCEDOR DE PASTA ELECTRICAS

93133-10 CP9-2E
93134-10 CP9-4E

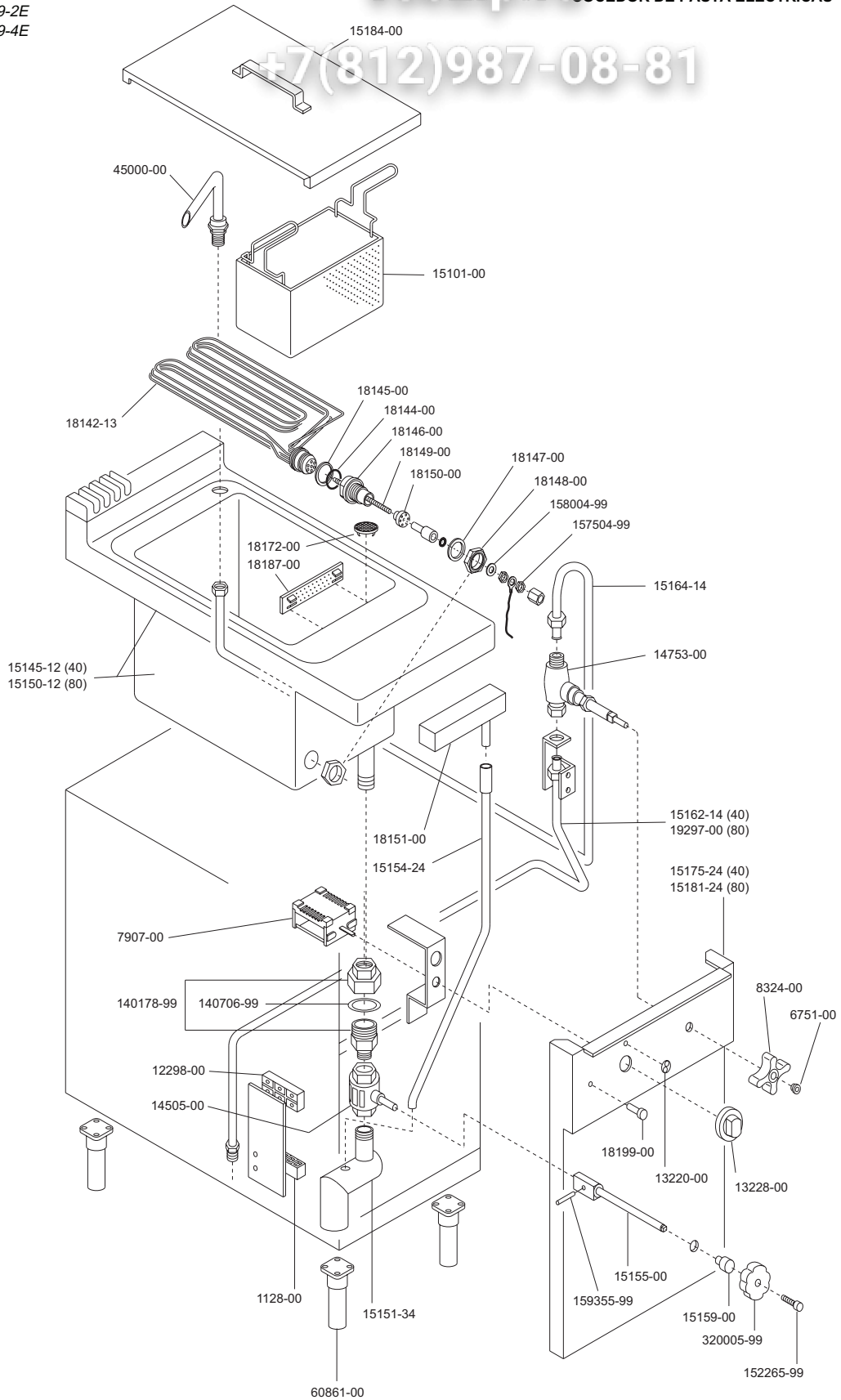

| | | | | | | |
|--|-----------------------|------------|--|--------------------|-----|------------|
|  MARENO INDUSTRIE ALI spa Mareno di Piave (TV) | ELABORATO: | APPROVATO: | GRUPPO: | DENOMINAZIONE: | | |
| | <i>Plinelli</i> | | Serie 900 | Impianto elettrico | | |
| | DATA: | DATA: | PARTICOLARE: | REV. N. | DEL | DISEGNO N. |
| | 10 Nov 96 | 10 Nov 96 | Disegno esploso per ricambi | ▼ | ▼ | ▼ |
| SOST. DIS. | Z01 - 9611.3.9.18.CPE | | Z 0 1 - 9 6 1 1 . 3 . 9 . 1 8 . C P E | | | |



S900-CE

CUOCIPASTA ELETTRICI
ELECTRIC HEATED PASTA COOKER
CUISEUR A PATES ELECTRIQUES
ELEKTROBEHEIZTE TEIGWARENKOCHER

MOD.

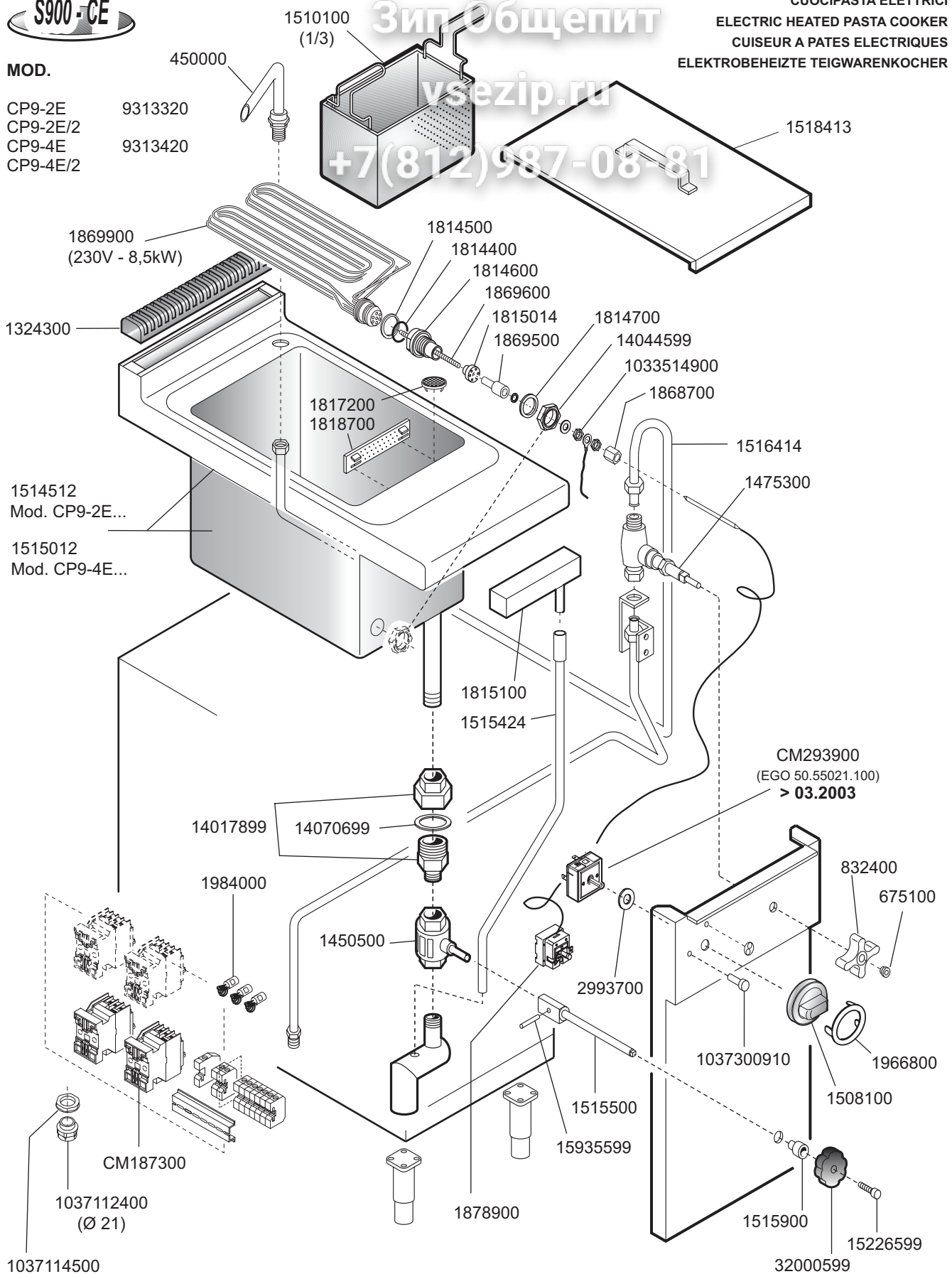
CP9-2E 9313320
 CP9-2E/2
 CP9-4E 9313420
 CP9-4E/2



| | | | | | | |
|--|---------------------|-------------|---|----------------|------|------------|
|  MARENO INDUSTRIE ALI spa Mareno di Piave (TV) | ELABORATO: | APPROVATO: | GRUPPO: | DENOMINAZIONE: | | |
| | Z. G. | | Serie 90 | Impianto gas | | |
| | DATA: | DATA: | PARTICOLARE: | REV. N. | DEL | DISEGNO N. |
| | 10 Nov 1996 | 10 Nov 1996 | Disegno esploso per ricambi | Z01 | 0803 | 3.9.37 |
| SOST. DIS. | Z00 9611 3.9.37.CPE | |  | | | |