

vsezip.ru

+7 812 987 06 81

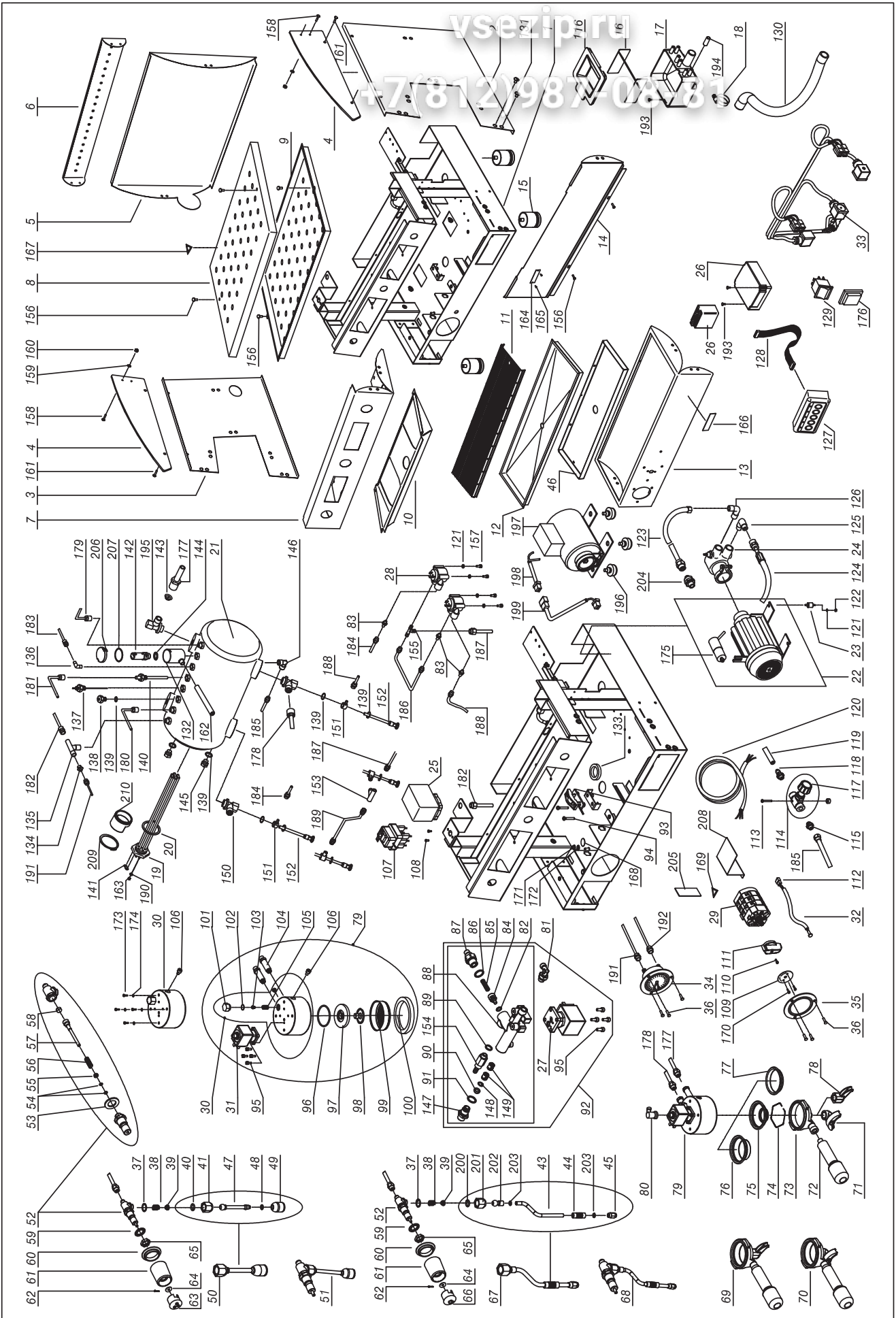

Exploded view CAPRI DELUXE update 07-13

## EXPLODED DIAGRAM CAPRI DELUXE UPDATE 07-13

vsezip.ru

POS.	CODE	DESCRIPTION
1A	10023012A	FRAME CA DLX 2GR CB BLACK
1B	10023102A	FRAME CA DLX 1GR CB BLACK
2A	10022765B	R.H. SIDE PANEL CA BLUE
2B	10022766B	R.H. SIDE PANEL CA BLACK
2C	10022802B	R.H. SIDE PANEL CA RED
2D	10022814B	R.H. SIDE PANEL CA WHITE
3A	10022768B	L.H. SIDE PANEL CA BLUE
3B	10022769B	L.H. SIDE PANEL CA BLACK
3C	10022803B	L.H. SIDE PANEL CA RED
3D	10022816B	L.H. SIDE PANEL CA WHITE
4	10352031A	R.H./L.H. CUP GUARD CA
5A	10022760C	SS REAR PANEL CA 2GR
5B	10022786C	SS REAR PANEL CA 1GR
6A	10022778	REAR CUP GUARD BLACK CA 2GR
6B	10022779	REAR CUP GUARD BLUE CA 2GR
6C	10022795	REAR CUP GUARD. BLUE CA 1GR
6D	10022807	REAR CUP GUARD RED CA 2GR
6E	10022809	REAR CUP GUARD BLACK CA 1GR
6F	10022811	REAR CUP GUARD RED CA 1GR
6G	10022812	BACK CUP RETAINER WHITE CA 2GR
6H	10022818	BACK CUP RETAINER WHITE CA 1GR
7A	10023030	TOP FRONT PANEL CA 2GR SED CB
7B	10023032	TOP FRONT PANEL CA 2GR SAP CB
7C	10023108	TOP FRONT PANEL CA 1GR SED CB
7D	10023112	TOP FRONT PANEL CA 1GR SAP CB
8A	10015442A	TOP GRILLE CA 2GR XLC CB
8B	10015444A	TOP GRILLE CA 1GR XLC CB
9A	10015440A	TOP TANK CA 2GR XLC CB
9B	10015446A	TOP TANK CA 1GR XLC CB
10A	10022758A	LOW GROUP HEAD PROTECTION CA 1GR
10B	10015312A	LOW GROUP HEAD PROTECTION CA 2GR
11A	10015532	DRAIN GRID CA 1GR FILINOX
11B	10015534	DRAIN GRID CA 2GR XLC FILINOX
12A	10015532A	DRIP TRAY CA 2GR XLC CB
12B	10015836	DRAIN PLATE CA 1GR XLC
13A	10023028	BOTTOM FRONT PANEL CA DLX 2GR CB SCREEN PRINTED
13B	10023106	BOTTOM FRONT PANEL CA DLX 1GR CB SCREEN PRINTED
14A	10023024	FRONT PROTECTION CA 2GR CB
14B	10023104	FRONT PROTECTION CA 1GR CB
15	10352065	TELESCOPIC FOOT D50X55 INOX
16	10012144	FLOW REGULATOR FOR DRIP TRAY
17	10022441A	DRIP TRAY HOLE W/RESCA D. 14
18	10806099	SS HOSE CLAMP
19A	10455050	RESISTOR 1950W 220V 1GR
19B	10455051	RESISTOR 1950W 120V 1GR
19C	10455052	RESISTOR 2700W 220V 2GR
19D	10455053	RESISTOR 2700W 120V 2GR
19E	10455060	RESISTOR 2400W 220V 1GR
19F	10455065	RESISTOR 2400W 120V 1GR
19G	10455076	RESISTOR 4000W 220V 2GR
19H	10455080	RESISTOR 4500W 220V 2GR
20	10502020	PTFE WASHER D56X41X2mm
21A	10002635B	COPPER BOILER 1GR D.180
21B	10002670	COPPER BOILER 2GR 10 LITRES D.190
22	10252098A	EL. MOTOR 130W 230V CB 1-2GR INTERNAL
23	10255022	VIBRATION DAMPING BUFFER
24	10252070B	ROTARY PUMP 150L/H W/CLAMP
25	10602010A	PRESSURE SWITCH
26A	10112010A	LEVEL CONTROL SAP 230V
26B	10112011	LEVEL CONTROL SAP 120V
26C	10112012	CONTROL UNIT XLC SED 120V

POS.	CODE	DESCRIPTION
26D	10112072E	CONTROL UNIT XLC SED 230V
27A	10303093A	2-WAY SOLENOID VALVE BAS. 32X32 230V
27B	10303100	2-WAY SOLENOID VALVE BAS. 32X32 120V
28	10112290	VOLUMETRIC METER 1/8"
29A	10122050	SINGLE-PHASE JUMPER SWITCH
29B	10122060	THREE-PHASE JUMPER SWITCH
30	10052028A	SPOUT ASSEMBLY RING W/FILTER DISK AND GASKET E61
31A	10302066	LOW 3-WAY SOL. V. 32X32 230V
31B	10305555	LOW 3-WAY SOL. V. 32X32 120V
32A	10553021	ORANGE IND. LIGHT D6 230V WIRED
32B	10553024	ORANGE IND. LIGHT D6 120V WIRED
33A	10102155A	WIRING CA 2GR SAP
33B	10109103B	WIRING CA 1GR SED XLC
33C	10109104B	WIRING CA 2GR SED XLC
33D	10109110B	WIRING CA 1GR SAP
34	10552021A	PRESSURE GAUGE
35	10552022A	FLANGE FOR SELECT. SWITCH
36	10805069	SCREW (HEX.CONV.SO) M3X10 A2
37	10402056A	O RING 2062 VITON
38	10402043	ARTIC. JOINT SPRING
39	10402054	ARTIC. JOINT CAP
40	10402063A	O RING 115 EPDM
41	10402022B	ARTIC. JOINT NUT
42	10858589	ARTICULATED JOINT
43	10402257	CAPRI STEAM LANCE D. 10
44	10753052	STEAM THERMOBLOCK TUBE
45	10402279	4-HOLE STAINLESS STEEL NOZZLE
46A	10023022	BRACKET CONTROL UNIT PROTECTION CA 2 CB
46B	10023110	BRACKET CONTROL UNIT PROTECTION CA 1 CB
47	10022140	WATER DISPENSING TUBE
48	10502041A	O RING 2025 EPDM
49	10402140	DISPENSING HEAD
50	10402145	COMPLETE WATER NOZZLE CA
51	10402010	COMPLETE WATER TAP CA
52	10402120B	TAP BODY
53	10505561	TAP COPPER BUSHING
54	10505121	O RING NBR TAP ROD
55	10402015	TAP ROD BUSHING
56	10402014	TAP ROD SPRING
57	10402061	CENTRAL TAP ROD
58	10505558	TAP ROD SEAL
59	10806312	SERRATED WASHER D21 ZN
60	10402070	KNOB RING NUT
61	10402074	TAP KNOB
62	10806370B	TAP SPLIT PIN
63	10351115	WATER TAP KNOB CAP PRINTED
64	10402040	TAP BRASS WASHER
65	10402028	CHROMED RAISED HALF NUT 1/2"
66	10351114	STEAM TAP KNOB CAP PRINTED
67	10402260A	COMPLETE CA STEAM LANCE D.10
68	10402230A	COMPLETE CA STEAM TAP D. 10
69	10402121D	1-CUP FILTER HOLDER ASSY
70	10402122C	2-CUP FILTER HOLDER ASSY
71A	10052088	SMALL 2-WAY SPOUT, OPEN
71B	10052090	2-WAY SPOUT
72	10052040	FILTER-HOLDER HANDLE
73	10052030	FILTER-HOLDER BODY
74	10052055	FILTER RETAINER SPRING 1.3
75	10052100	1-CUP FILTER
76	10052110	2-CUP FILTER
77	10052220	SOLID FILTER

POS.	CODE	DESCRIPTION	POS.	CODE	DESCRIPTION
78A	10052078	SMALL 1-WAY SPOUT, OPEN	131	10805028	TRUSS HEAD SCREW - M6X10 A2
78B	10052080	1-WAY SPOUT, OPEN	132	10022480A	STAY PIPE TAP K D14
79A	10052206A	RING ASSY. CA GDE61 230V	133	10105030	CABLE GLAND IN BLACK RUBBER
79B	10052208A	RING ASSY. CA GDE61 120V	134	10852580A	STRAIGHT-UNION 1050 6-1/4"M
80	10255028A	SWIVEL ELBOW F1/8	135	10852821	2070 1/4 T-UNION M/F/F
81	10255058	L-UNION ROTATING 1/8M	136	10852250A	1020 6-1/4"M ELBOW
82	10402068	OR 106 NBR	137A	10112042	LEVEL SENSOR 140mm CA 2GR
83	10852080A	STRAIGHT-UNION 1050 6-1/8"M	137B	10112064	LEVEL SENSOR 120mm CA 1GR
84	10058027	FILLING BLOCK PISTON VR	138	10652040A	BOILER RELIEF VALVE
85	10053110	FILLING BLOCK SPRING VR	139	10852180	COPPER WASHER 1/4"
86	10053109	COPPER WASHER FILLING BLOCK VALVE VR	140	10853053A	STRAIGHT SUCTION PIPE 1/4"M
87	10058042	NIPLESS VALVE LIGHT FILLING BLOCK	141	10106060	BRASS RESISTOR CONNECTION JUMPER
88	10058040	BODY LIGHT FILLING BLOCK	142	10652012B	SAFETY VALVE
89	10058048	COPPER WASHER 1/8" LIGHT FILLING BLOCK	143A	10052174	JET HOLE D2.5
90	10355172	ROUND MESH FILTER	143B	10052176	JET HOLE D3
91	10058050	COPPER WASHER 1/4" LIGHT FILLING BLOCK	143C	10052178	JET HOLE D3.5
92A	10056110	LIGHT FILLING BLOCK ASSY. 230V EV.32X32	143D	10052179	GIGLEUR HOLE D2
92B	10056121	LIGHT FILLING BLOCK ASSY. 120V EV.32X32	144	10806324	COPPER WASHER 3/8"
93	10105022	CABLE GLAND PA268	145	10852540	2611 1/4"M PLUG
94	10105024	SCREW TC + 3.5X25 ZN	146	10852060A	1020 8-1/4"M ELBOW
95	10805071	SCREW (HEX.CH.SOCK.) M4X10 A2	147	10058044	UNION 1/4-1/4 LIGHT FILLING BLOCK
96	10502070A	OR 3187 EPDM FDA	148	10806288	O-RING LIGHT FILLING BLOCK
97	10052248	MAZZOCCO RING ASSY. X GASKET AND FILTER DISK E61	149	10652052	CHECK VALVE
98	10052141	DIFFUSER GR. E61	150	10853298	BOTT. H.EXCHANGER UNION 1/4"-3/8"-3/8"
99	10052120	MESH FILTER DISK ASSY. E61	151	10852240A	1170 6-1/4" JOINT CONNECTION
100	10502110	UNDERCUP GASKET ASSY. E61	152	10042040A	INJECTOR PTFE D.8
101	10052142	RING GROUP HEAD JET CLOSING CAP	153	10852780	2090 1/8 T-UNION M/F/M
102	10052143	RING GROUP UPPER CAP GASKET	154	10655557	EXPANSION VALVE
103	10052135	GROUP HEAD JET HOLE D.O.8	155	10852028A	1010 6-6-1/8"M TEE
104	10852033	EXTENSION NI CA RING GROUP HEAD	156	10805027A	SCREW TBL + M4X10 A2
105	10052136	GROUP HEAD FILTER E-61/RING	157	10805074	HEX-HEAD SCREW M4X8 ZN
106	10805078	SCREW (HEX CH SOCK) M6X8 A2	158	10805027	TRUSS HEAD SCREW - M4X10 A2
107	10111015	THERMOSTAT W/ MANUAL RESET	159	10803546	PLAIN WASHER D4 A2
108	10805872	CHEESEHEAD SCREW + M4X6 ZN	160	10805584	CAP NUT 4MA A2
109	50302050	SELECTOR SWITCH LABEL SER.012	161	10805018	TRUSS HEAD SCREW - M4X12 A2
110	10122011	SWITCH KNOB SCREW	162	10905024	SILICONE HOSE D12X18
111	10122015	SWITCH KNOB	163	10806050	NUT M4 X RESISTOR
112	10105180	2-WAY BLOCK M.	164A	10952051B	AL RATING PLATE SAN REMO 230V
113	10803010	CHEESEHEAD SCREW - M4X40 ZN	164B	10952052B	AL RATING PLATE SAN REMO 400V
114	10402067	DRAIN TAP W/KNOB	164C	10952053A	AL RATING PLATE SAN REMO 120V
115	10852050A	1050 8-1/8"M STRAIGHT COUPLING	165	10805950	TEAR-OFF RIVET D3x6
116	10022476B	1050 8-1/8"M STRAIGHT COUPLING	166A	10955018A	SAN REMO LABEL 70X11.3
117	10402060	BOILER DRAIN TAP KNOB	166B	10955020A	SAN REMO LABEL 101X16.5
118	10853058	1510 STRAIGHT OUTLET CONNECTOR 6-1/8"M	167	10955013A	HOT SURFACE TRIANG. LABEL
119	10905010	TRANSP. SILICONE TUBE	168	10955025A	EARTH TRIANG. LABEL
120A	10102190	POWER CABLE 3X2.5 M3 N5 SINGLE-PHASE	169	10955015	VOLTAGE TRIANG. LABEL
120B	10102191	POWER CABLE 5X2.5 M3 N4 THREE-PHASE	170	10809019	BURNISHED SCREW (HEX CONV SOCK) M3X8
120C	10102193	POWER CABLE 3X4 M3 N7	171	10809012	FLANGED NUT 6MA ZN
120D	10102196	POWER CABLE 3x12AWG SJOOW 3MT	172	10803536	SERRATED WASHER D6.2 ZN
120E	10102197	POWER CABLE 3x14AWG SJOOW	173	10805075	HEX-HEAD SCREW M5X8 ZN
121	10803519	SERRATED WASHER D4.2.ZN	174	10803520	SERRATED WASHER D5.3 ZN
122	10805512	MEDIUM-HEIGHT NUT 4MA ZN	175	10252038	MOTOR CAPACITOR 150W
123	10852484	STAY PIPE L=2000	176	10105243B	TRANSPARENT SWITCH CAP
124	10852470	STAY PIPE L=450	177A	10003050	TUBE TOP HEAT EXCHANGER CA 2 DLX CB
125	10852530A	1020 10-3/8"M ELBOW	177B	10003270	TUBE TOP HEAT EXCHANGER CA 1 DLX CB
126	10852280A	1020 8-3/8"M ELBOW	178A	10003052	TUBE BOTT. HEAT EXCHANGER CA 2 DLX CB
127	10112066A	PUSHBUTTON STRIP FOR DISP.3D5	178B	10003272	TUBE BOTT. HEAT EXCHANGER CA 1 DLX CB
128A	10112078	PIN TO PIN CABLE 600mm	179A	10002055B	STEAM HOSE RH CA 2 CB
128B	10112079	PIN TO PIN CABLE 800mm	179B	10003276	STEAM HOSE RH CA 1 CB
129	10555060C	COFFEE SWITCH W/SCREEN PRINT	180	10002052	STEAM TUBE LH CA 2
130	10852460	HELICALLY WOUND DRAIN PIPE L.2 M	181A	10002126	HOT WATER RUN-OFF TUBE CA 1

POS.	CODE	DESCRIPTION
181B	10002126	HOT WATER RUN-OFF HOSE CA 1
182A	10003164	PRESSURE SWITCH TUBE CA 2 DLX CB
182B	10003274	PRESSURE SWITCH TUBE CA 1 XLC CB
183A	10003160	BOILER FILL HOSE CA 2 CB
183B	10003174	BOILER FILL HOSE CA 1 CB
184A	10003166	FILL HOSE 1°GR CA 2 DLX SED CB
184B	10003176	FILL HOSE 1°GR CA 1 DLX SED CB
185A	10002196	BOILER DRAIN HOSE CA 2
185B	10002236	BOILER DRAIN HOSE CA 1
185B	10002196	BOILER DRAIN HOSE CA 2
186	10002060	CONNECTION TUBE VOLUM. MEAS. 1-2 CA 2 SED
187A	10003162	FILL HOSE VOLUM. CA1-2 DLX SED CB
187B	10003170	FILL HOSE GR CA 2 SAP CB
187C	10003178	FILL HOSE GR CA 1 DLX SAP CB
188	10003168	FILL HOSE 2°GR CA 2 DLX SED CB
189	10003172	JUMPER TUBE 1°-2°GR CA 2 SAP CB
190	10809024	WASHER D.4.3 COPPER
191	10002030	BOILER PRESS. SW. CAPILLARY TUBE CA 1-2 XLC
192	10002024	PUMP PRESS. SW. CAPILLARY TUBE CA 1-2 XLC
193	10805084	SCREW TC + M4X10 ZN
194	10052064	DRIP TRAY CAP
195	10853296	TOP. H.EXCHANGER UNION 3/8"-3/8"
196	10352058	EXTERNAL PUMP FOOT
197	10252096	EL. MOTOR 150W 230V PE. 1-2-3GR CB
198	10102595A	CONNECT. WIRING MACHINE TO EXT. PUMP
199	10102620A	CONNECT. WIRING MOTOR E.P. 2GR
200	10402082	LANCE SWIVEL JOINT O-RING D. 10
201	10402282	STEAM LANCE NUT MLX
202	10402288	LANCE BALL SWIVEL JOINT MLX
203	10402081	LANCE TUBE O-RING MLX
204	10355150	PUMP FILTER 3/8" FITTING
205	10955033	LABEL 220/240V CABLE
205	10955034A	LABEL 380/400V CABLE
206	10022497A	SAFETY VALVE TANK COVER
207	10505085	OR 3162 SILICON
208	10023114	BRACKET SWITCHER UNIT PROTECTION 1GR CB
209	10806286	O-RING A52X2 A2
210	10455100B	RESISTOR PROTECTION